

METER SIZE	VAULT SIZES			
	CATALOG#	VAULT#	COVER#	BASE#
3"	575-LA	575-BL	57TL-30C	575-BL
4"	575-LA	575-BL	57TL-30C	575-BL
6"	675-LA	675-ML	675-TL-30C	675-BL

GENERAL NOTES:

- SHOP-COAT ALL INTERIOR METAL INCLUDING PIPE, FITTINGS AND PIPE STANDS WITH TWO COATS OF FARWEST, BLUE, QUICK-DRY ENAMEL, PART NO. 250-1-01-K-04 AS APPROVED BY THE ENGINEER. APPLY PER MANUFACTURERS INSTRUCTIONS. SAND BLAST TO REMOVE EXISTING COATINGS AND PAINT PRIOR TO INSTALLATION, THEN TOUCHUP AS REQUIRED.
- THE ABOVE VAULT SIZES WERE SUPPLIED BY UTILITY VAULT CO. AS A REFERENCE FOR REQUIRED VAULT DIMENSIONS. SHOP DRAWINGS SHALL BE SUBMITTED FOR APPROVAL.
- ALL ACCESS COVERS SHALL BE TRAFFIC BEARING, UTILITY VAULT FRAME NO. 332 w/ 332P COVER AS REQUIRED BY DISTRICT. PROVIDE RECESSED DOOR HANDLE BOX FOR PADLOCK w/ BOLT-DOWN COVER OVER LOCK, BOX SHALL BE LARGE ENOUGH FOR "MASTER LOCK".
- CLASS 52 D.I. PIPE IS REQUIRED.
- ALTERNATE METHODS OF RESTRAINT SHALL BE APPROVED BY THE DISTRICT.
- ALL BRASS FITTINGS SHALL CONFORM TO AWWA C800. (PARTS 9,10,11,12,13 & 14)

MATERIAL LIST

- HATCH ————— CAST IRON MANHOLE OR GALV. STEEL HATCH IN TRAFFIC AREAS (SEE #3 ABOVE)
- LADDER RUNGS ——— 3/4" GALV. BAR AT 12" O.C. GROUTED OR FABRICATED GALV. STEEL LADDER SECURED AT TOP AND BOTTOM.
- CONCRETE VAULT ——— SUBMIT DETAILS FOR APPROVAL. (SEE TABLE ABOVE)
- METER ————— COMPOUND WATER METER FLG. x FLG. SUPPLIED BY DISTRICT.
- MAIN VALVE ————— TWO EACH, AWWA C515-01 (DUCTILE IRON BODY AND BONNET) AND AWWA C550-05:FLxMJ w/ RESTRAINTS OS&Y GATE VALVES w/ HANDWHEEL. MUST BE LOCATED INSIDE OF VAULT.
- COUPLING ADAPTOR — ONE EACH, CAST IRON, (FLANGE BY MECHANICAL JOINT) COUPLING ADAPTOR.
- FLOOR DRAIN ——— 4" PVC, SLOPED TO STORM SEWER OR DAYLIGHT TO DRAINAGE DITCH.  
ALTERNATE: WATERPROOF VAULT w/ XYPEX. ALTERNATE MUST BE APPROVED BY THE DISTRICT AND WILL BE ALLOWED ONLY IF DAYLIGHT DRAIN IS EXTENDED OVER 300 FEET.
- SPOOL ————— SPOOL PLANE-END x FLANGED D.I.P. (CL52)
- 1-1/2" VALVE ——— TWO EA. BRASS GATE VALVES FOR BY-PASS.
- BEND ————— TWO EA. 1-1/2 INCH 90° BRASS BENDS.
- UNION ————— ONE EA. 1-1/2 INCH TWO-PART UNION BRASS.
- BY-PASS PIPE ——— 1-1/2 INCH BRASS PIPE AS NEEDED.
- SADDLE ————— TWO EA. 1-1/2 INCH SMITH BLAIR TYPE 313 OR EQUAL.
- TEE ————— 1-1/2"x 1-1/2" BRASS TEE.
- BUSHING ————— 1 1/2"x 3/4" BUSHING WITH 3/4" PLUG.
- WATER MAIN ——— CLASS 52 DUCTILE IRON PIPE WITH MEGALUG RESTRAINED JOINTS.
- WALL FLANGE ——— TWO EACH

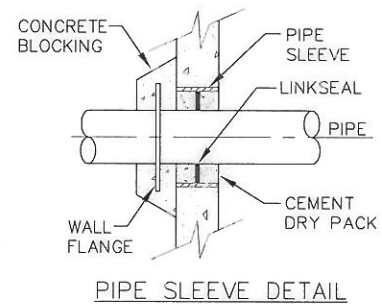

\* SEE SHEET 1 FOR ADDITIONAL DETAILS

SHEET 2 OF 2



Engineering Partners, LLC  
2600 116th Avenue NE #100  
Bellevue, Washington 98004  
Tel 425.869.9448

## 3", 4" & 6" METERS MAT'L. LIST & GENERAL NOTES



WATER DISTRICT NO.90

PLOTTING DATE MAY 2009	DRAWN DSH	CHECKED LDS	APPROVED <i>[Signature]</i>	DISTRICT TNH
PLOTTING SCALE NTS: 1=1	FILE NAME F:\DETAILS\WD90\WATER\0015-2		DATE APPROVED 5/08/09	

DWG. NO. 15-2